

**Sektionaltor
LS4000
BR400**

TECHNIK
Version 2019/03

LINDPOINTNER Torsysteme GmbH
Kalzitstrasse 12
A-4611 Buchkirchen
Tel. +43 7243/51 100-0
Fax. +43 7243/51 100-590
Web. www.lindpointner.com
Online-Shop. <https://eshop.lindpointner.com>



Gültig ab 01.03.2019

Alle bisherigen Unterlagen verlieren ihre Gültigkeit. Technische Änderungen, Druck- und Satzfehler, drucktechnische Farbabweichungen vorbehalten. Darstellungen sind nur beispielhaft.

Außenansicht

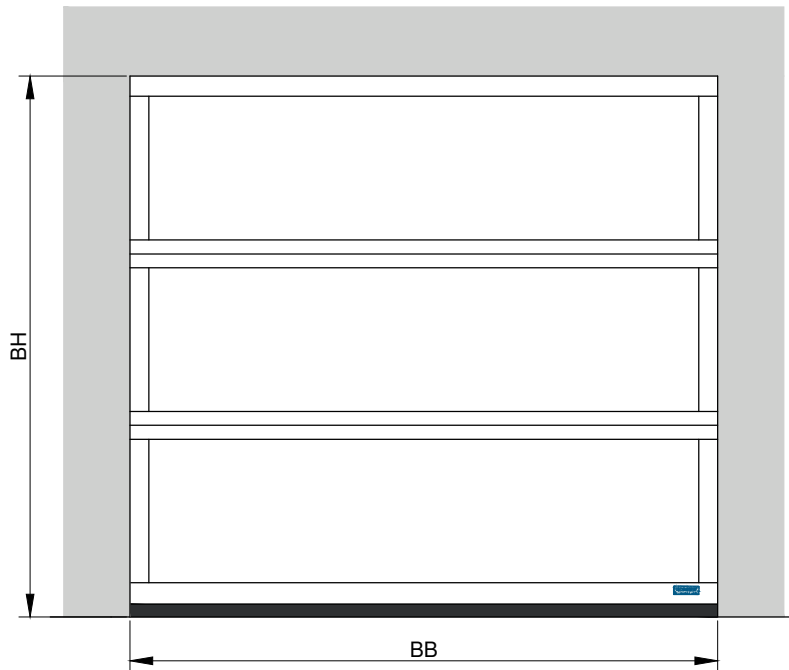

Horizontalschnitt

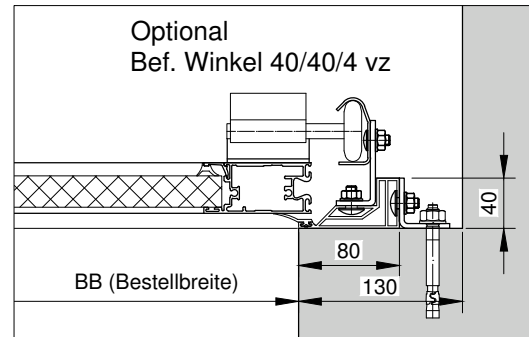
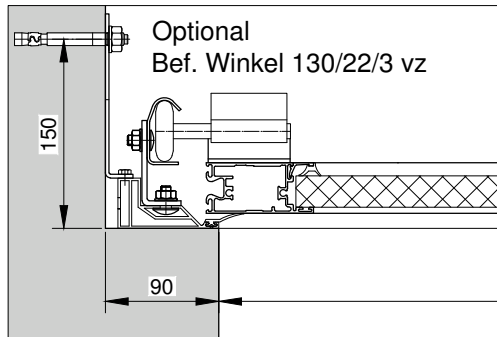

Detail Sturz

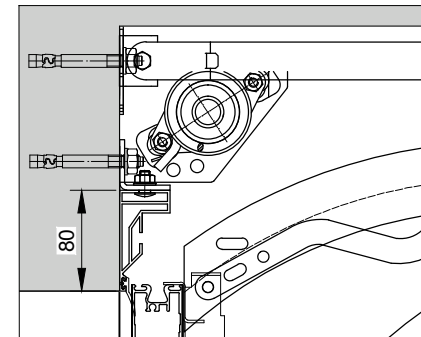

Detail Boden

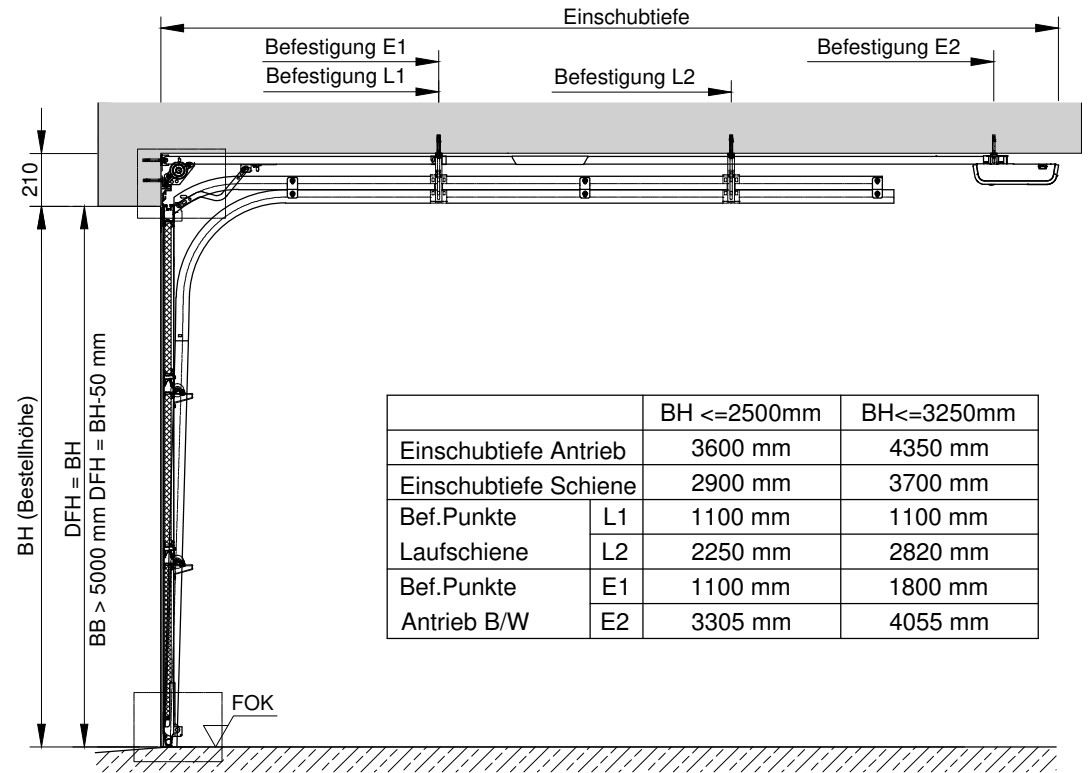
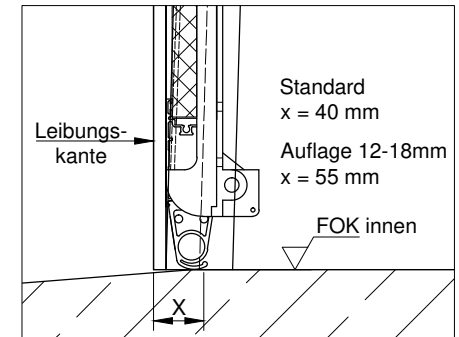

	BH <=2500mm	BH <=3250mm
Einschubtiefe Antrieb	3600 mm	4350 mm
Einschubtiefe Schiene	2900 mm	3700 mm
Bef.Punkte	L1	1100 mm
Laufschiene	L2	2250 mm
Bef.Punkte	E1	1100 mm
Antrieb B/W	E2	3305 mm
		4055 mm

Deckensektionaltor LS4000
Schienensystem A21-HDL
Normalsturz - Montage hinter der Leibung

LINDPOINTNER - Torsysteme GmbH, A-4611 Buchkirchen, Kalzitstraße 12

Zeich-Nr:
LS4000-AZ-A21-HL

Zeichner:

1:30

01-04-2018

Dateiname: L-AB-LS4000-AZ-A21-HL.DWG

LINDPOINTNER
TORSYSTEME

Außenansicht

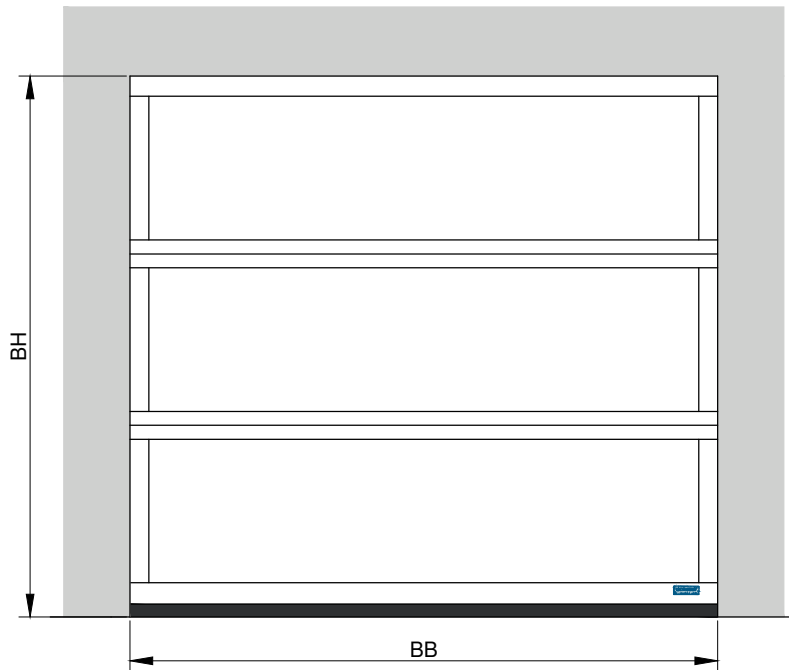

Horizontalschnitt

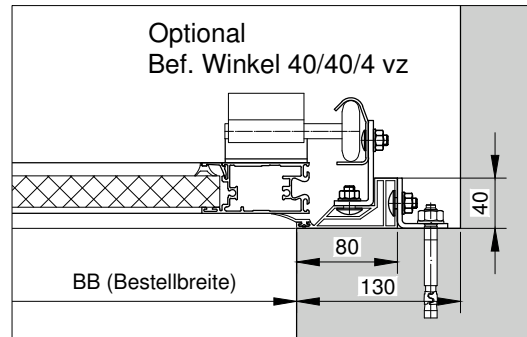
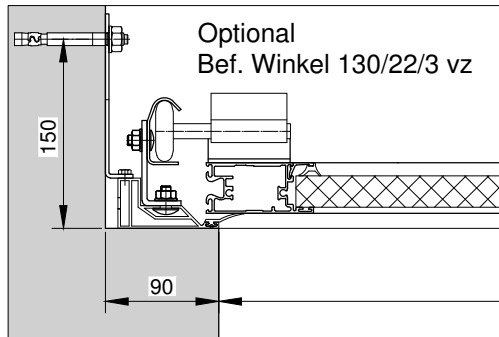

Detail Sturz

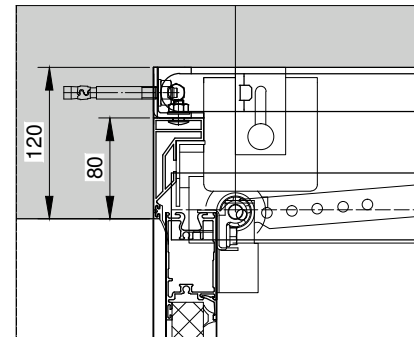

Detail Boden

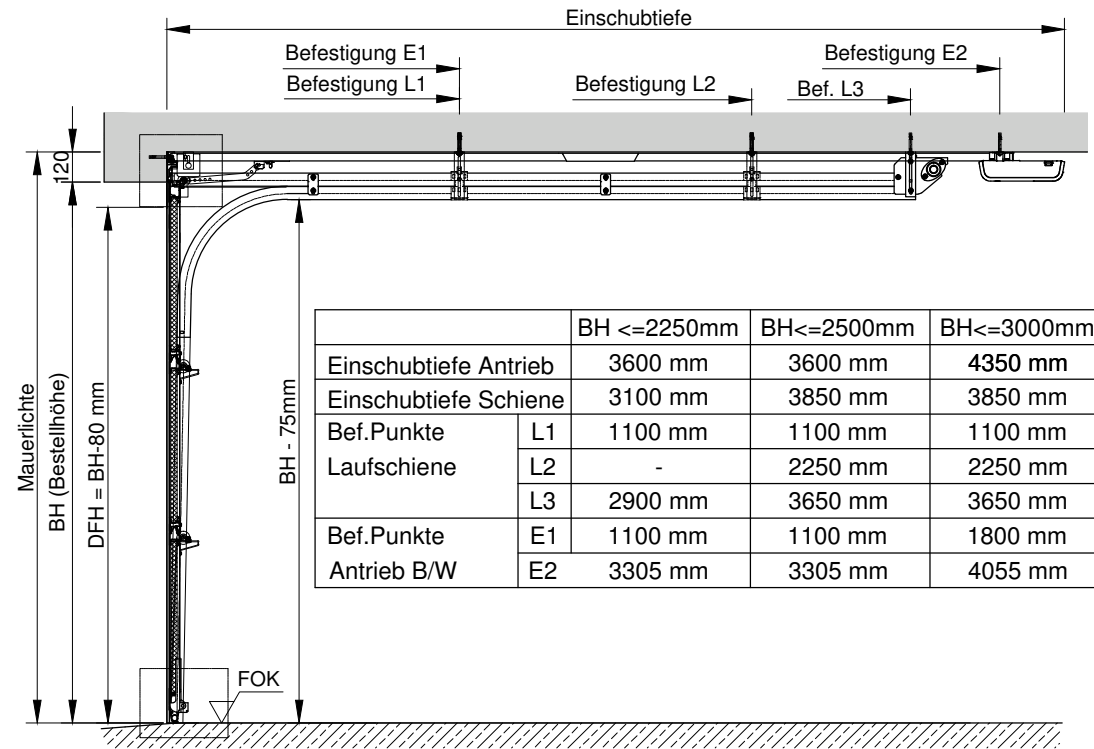
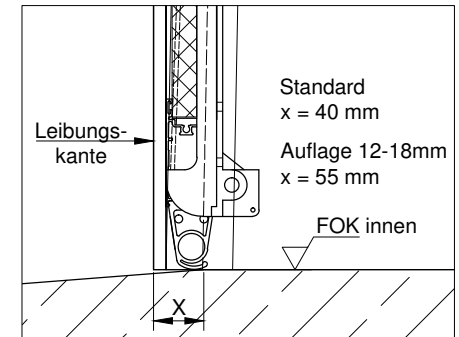

Deckensektionaltor LS4000
 Schienensystem A12-HDL
 Niedrigsturz - Montage hinter der Leibung

LINDPOINTNER - Torsysteme GmbH, A-4611 Buchkirchen, Kalzitstraße 12

Zeich-Nr:
 LS4000-AZ-A12-HL

Zeichner:

01-04-2018

Dateiname: L-AB-LS4000-AZ-A12-HL.DWG

LINDPOINTNER
 TORSYSTEME

Außenansicht

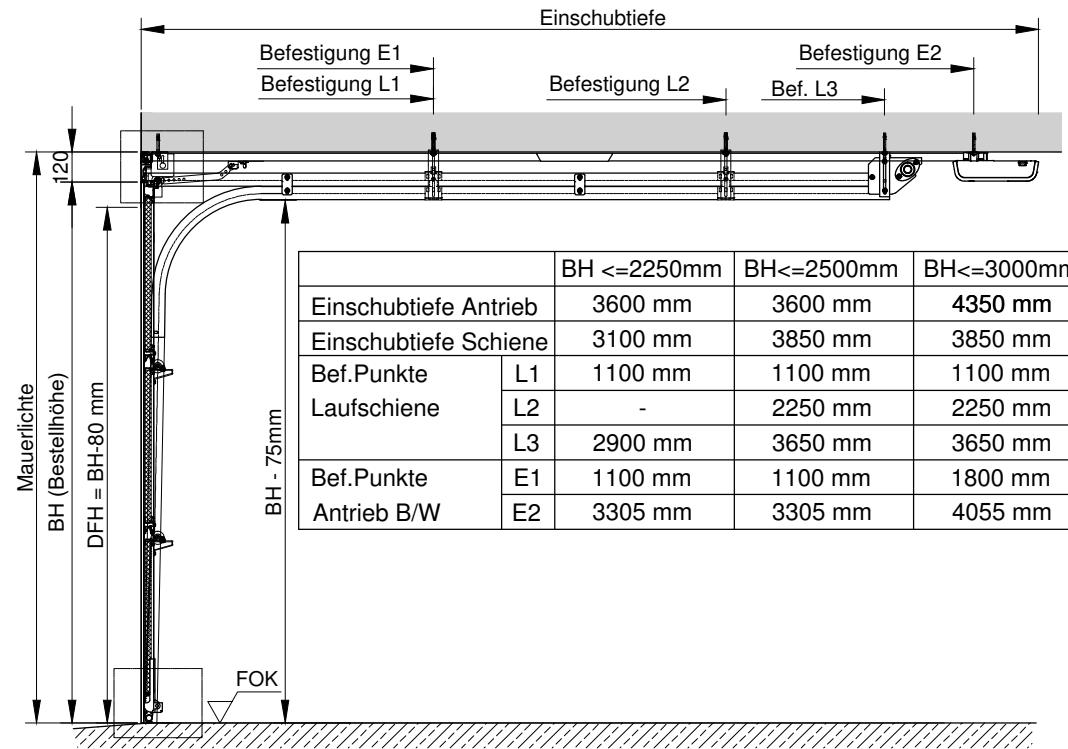
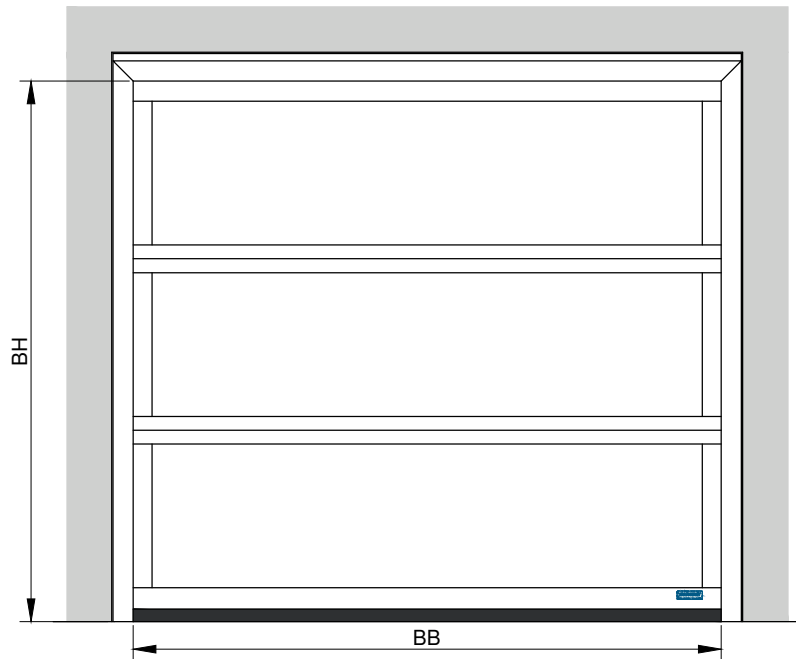

Horizontalschnitt

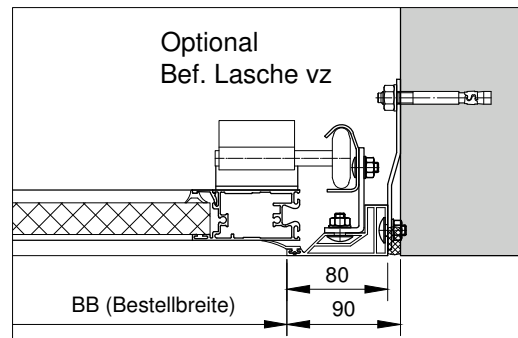
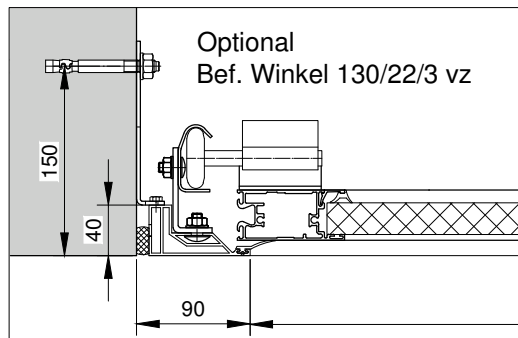

Detail Sturz

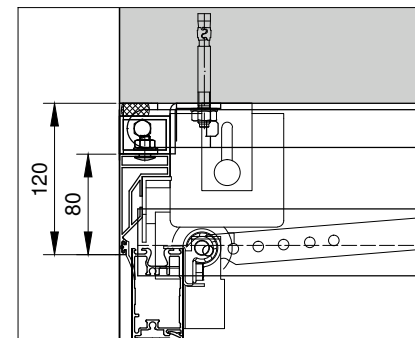

Detail Boden

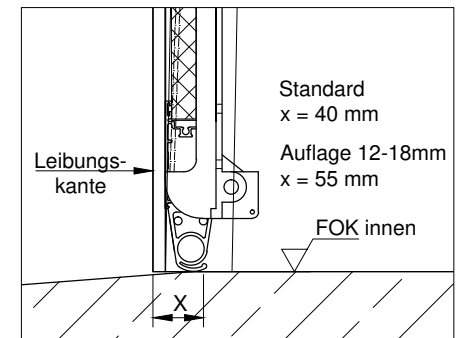

Deckensektionaltor LS4000
 Schienensystem A12-IDL
 Niedrigsturz - Montage in der Leibung

Zeich-Nr:
 LS4000-AZ-A12-IL

1:30

Zeichner:

01-04-2018

LINDPOINTNER - Torsysteme GmbH, A-4611 Buchkirchen, Kalzitstraße 12

Dateiname: L-AB-LS4000-AZ-A12-IL.DWG

LINDPOINTNER
 TORSYSTEME

Außenansicht

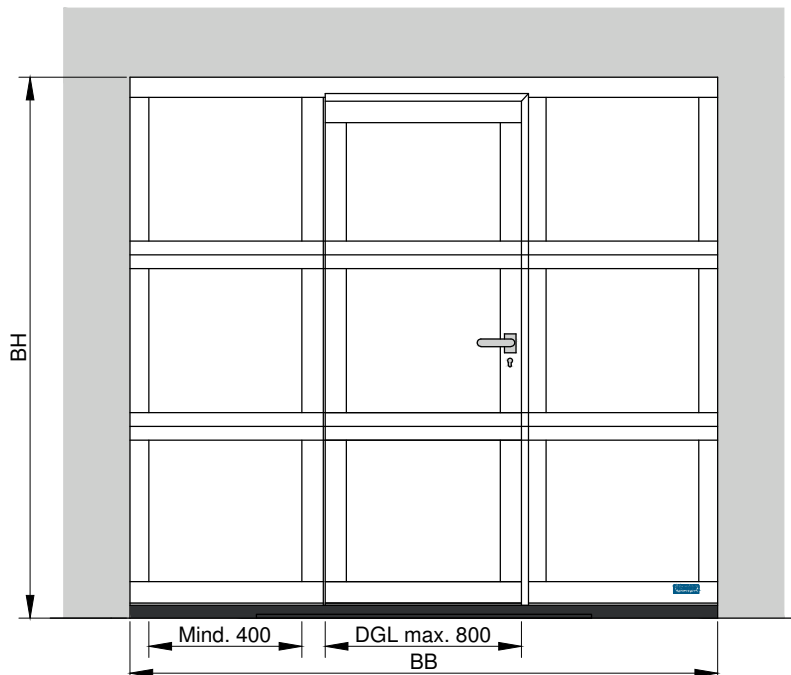

Horizontalschnitt

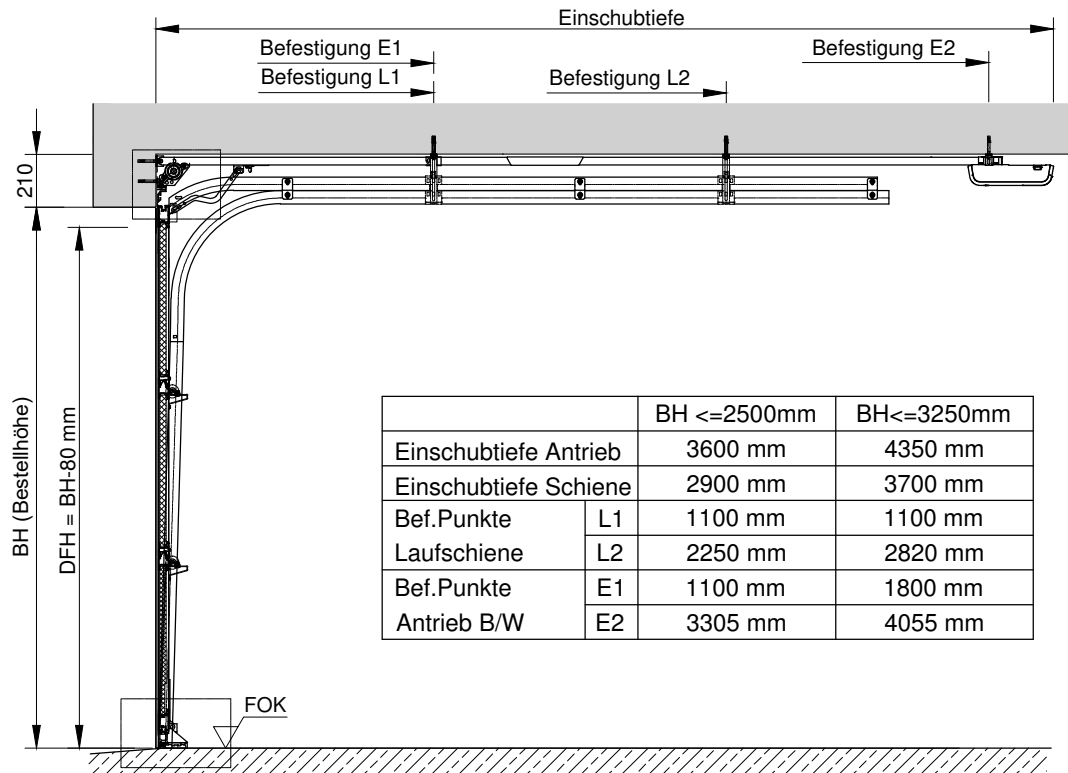

	BH <=2500mm	BH <=3250mm
Einschubtiefe Antrieb	3600 mm	4350 mm
Einschubtiefe Schiene	2900 mm	3700 mm
Bef.Punkte	L1 1100 mm	1100 mm
Laufschiene	L2 2250 mm	2820 mm
Bef.Punkte	E1 1100 mm	1800 mm
Antrieb B/W	E2 3305 mm	4055 mm

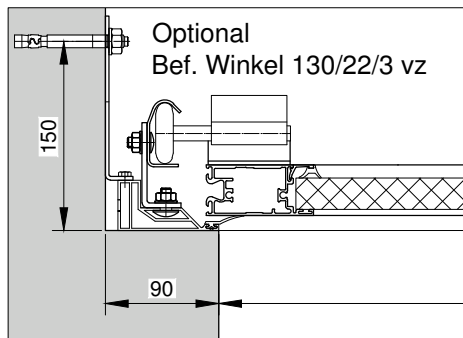

Optional
Bef. Winkel 130/22/3 vz

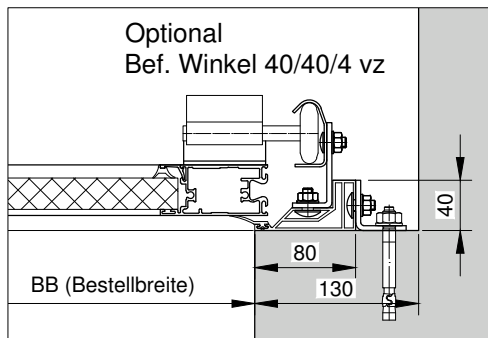

Optional
Bef. Winkel 40/40/4 vz

Detail Sturz

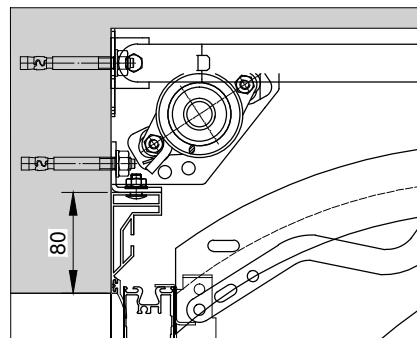

Detail Boden

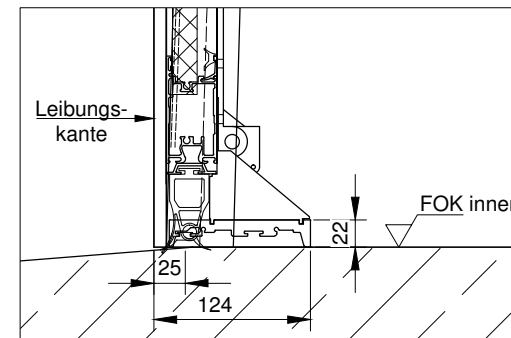

Deckensektionaltor mit Gektür Schwelle S22
Schienensystem A21-HDL
Normalsturz - Montage hinter der Leibung

Zeich-Nr:
LS4000-AZ-A21-HL-G

1:30

Zeichner:

01-04-2018

LINDPOINTNER
TORSYSTEME

Außenansicht

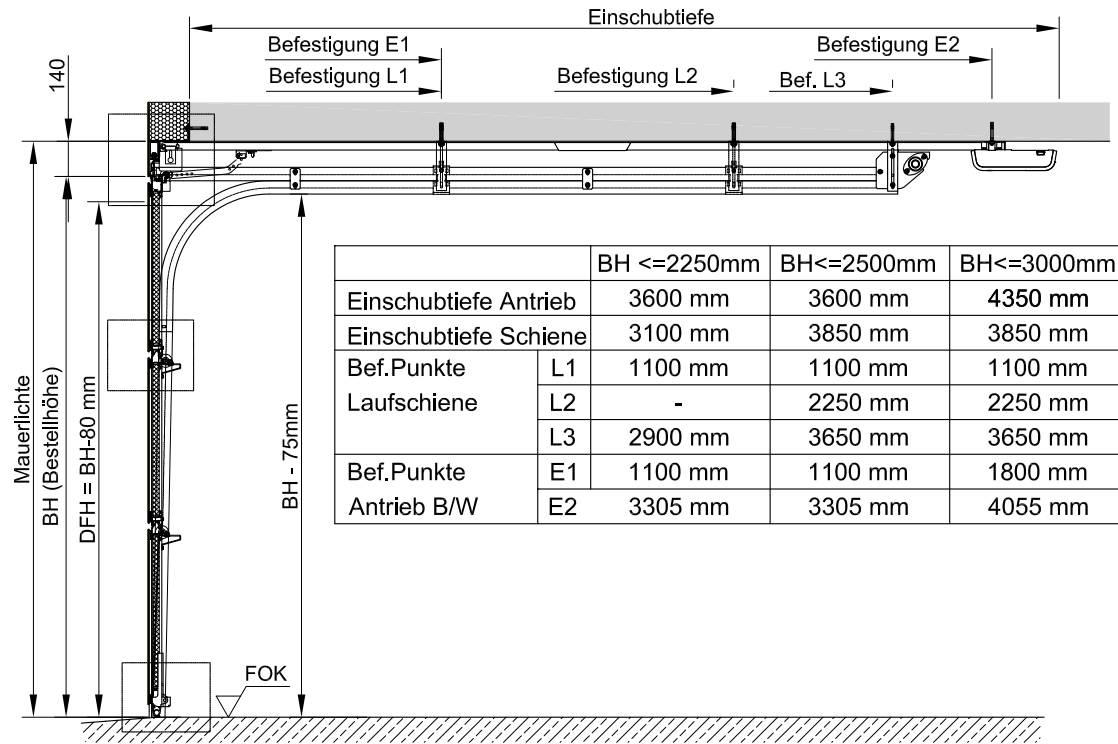
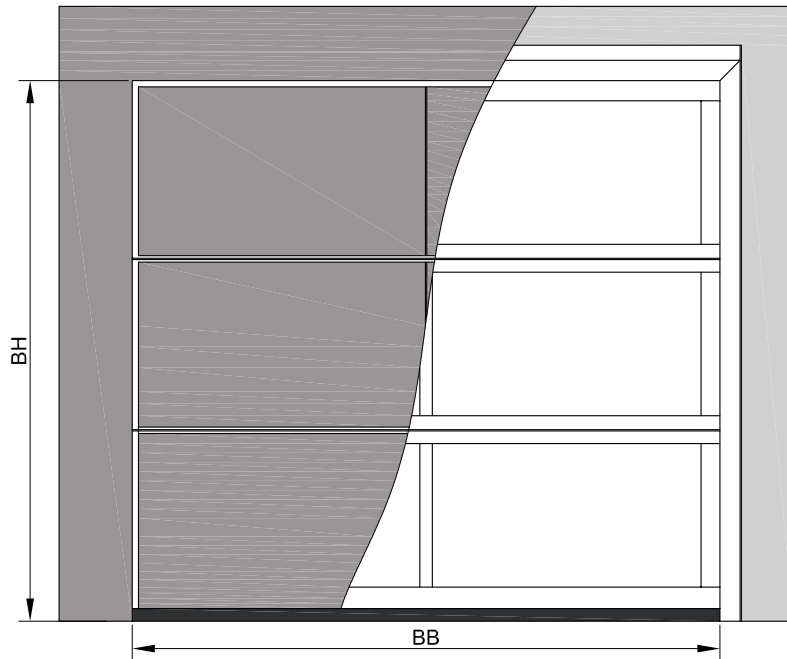

	BH <=2250mm	BH <=2500mm	BH <=3000mm
Einschubtiefe Antrieb	3600 mm	3600 mm	4350 mm
Einschubtiefe Schiene	3100 mm	3850 mm	3850 mm
Bef.Punkte	L1 1100 mm	1100 mm	1100 mm
Laufschiene	L2 -	2250 mm	2250 mm
	L3 2900 mm	3650 mm	3650 mm
Bef.Punkte	E1 1100 mm	1100 mm	1800 mm
Antrieb B/W	E2 3305 mm	3305 mm	4055 mm

Horizontalschnitt

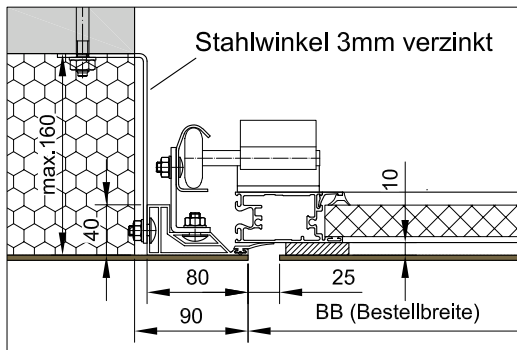

Detail Sturz

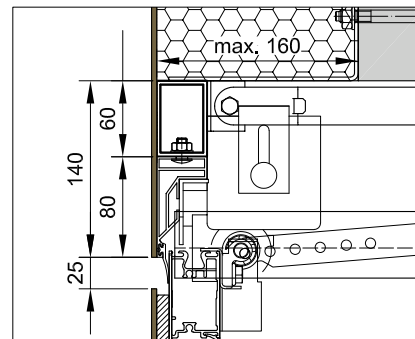

Detail Sektionen

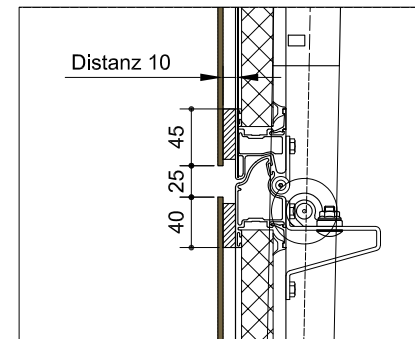

Detail Boden

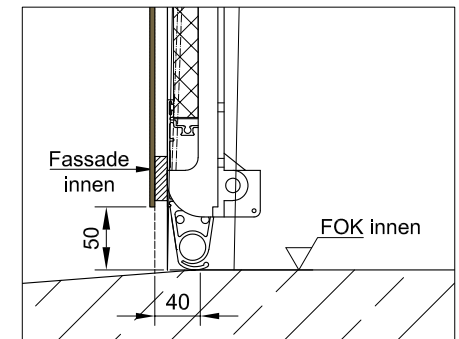

Deckensektionaltor LS4000
 Schienensystem A12-IDL
 Flächenbündig

LINDPOINTNER - Torsysteme GmbH, A-4611 Buchkirchen, Kalzitstraße 12

Zeich-Nr:

LS4000-Flächenb

-

Zeichner:

-

01-04-2018

Dateiname: L-AB-LS4000-FLÄCHENBÜNDIG.DWG

LINDPOINTNER
 TORSYSTEME